

Parts List				Parts List			
ITEM	QTY	PART #	DESCRIPTION	ITEM	QTY	PART #	DESCRIPTION
1	1	A01603	ADAPTOR PLATE	32	8	A19605	HEAD BOLT
2	1	A02002	BASE	33	1	A19620	SPACER
3	2	A02017	ROD BOLT	34	6	A19651	ROLL PIN
4	4	A02038	BOLT-MOTOR	35	4	A23004	WASHER
5	1	A02610	BEARING	36	2	*A04601	DIAPHRAGM
6	2	A02611	BEARING	37	2	*A07601	GASKET
7	1	A02633	SHAFT BUSHING	38	4	*A22002	4-40 SCREW
8	2	A03601	CAP	39	4	*A22601	VALVE
9	1	A03602	COUNTERWEIGHT	40	2	*A22605	VALVE STOP
10	1	A05601	ECCENTRIC	41	2	*A23001	WASHER
11	4	A06001	FOOT				
12	1	A06606	ACCESS PLUG				
13	1	A08601	HOUSING				
14	2	A08603	HEAD				
15	1	A13055	MOTOR				
16	4	A14001	CAP NUT				
17	4	A14009	NUT				
18	2	A16601	DIAPH. PLATE				
19	1	A16607	COVER PLATE				
20	2	A16608	COVER, HEAD				
21	2	A18601	CONROD				
22	1	A18602	TOL. RING				
23	2	A18603	TOL. RING				
24	4	A19005	SCREW				
25	2	A19007	PLATE SCREW				
26	1	A19008	SET SCREW				
27	4	A19009A	SCREW				
28	1	A19010	SET SCREW				
29	16	A19013	SCREW				
30	1	A19017	SCREW				
31	3	A19026	SCREW, ADAPTOR				

**\*RECOMMENDED SPARE PARTS KITS**

DIAPHRAGM KITS
11605 TEFLON/EPDM
11611 3-PLY TEFLON

INCLUDES ITEMS 36-41

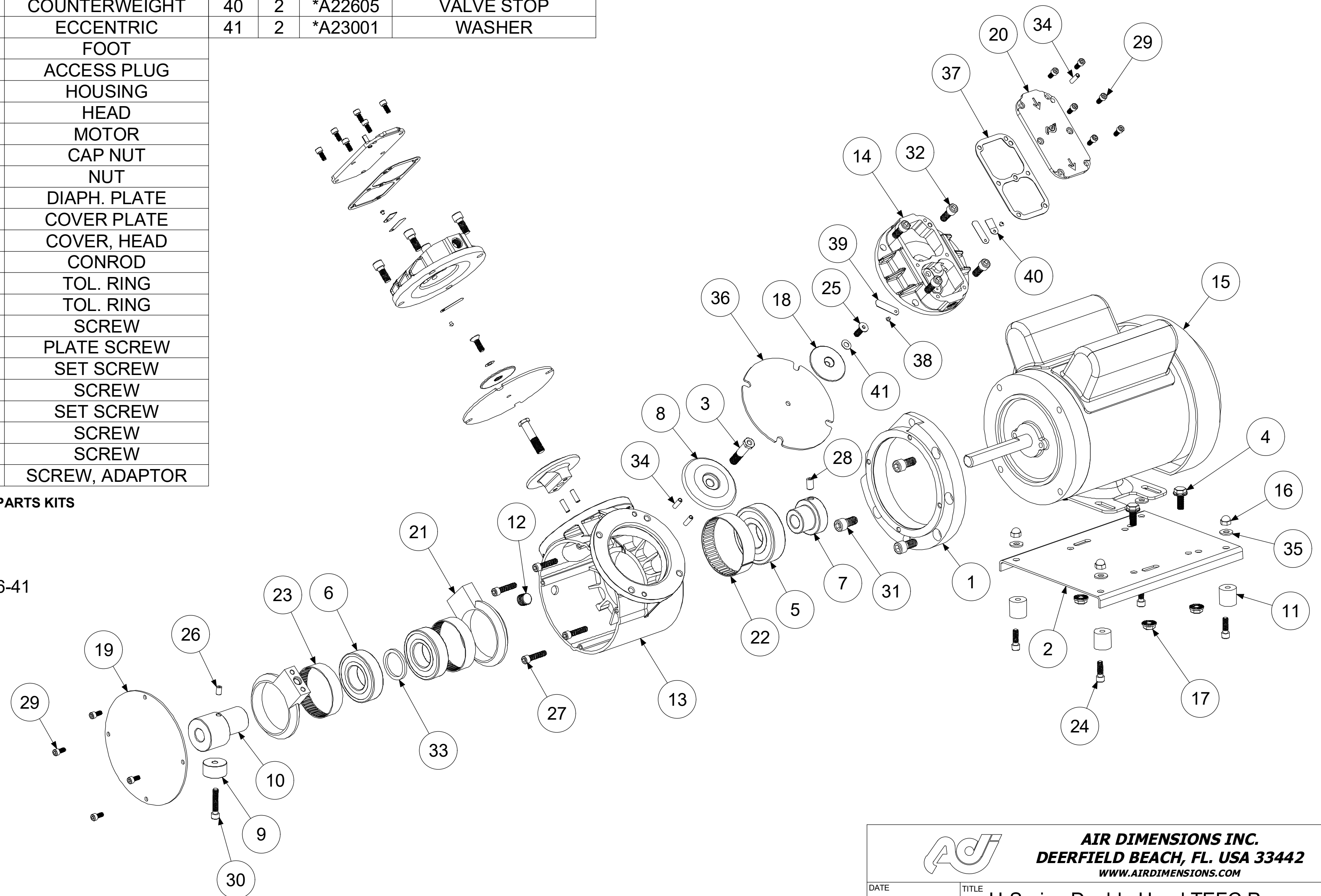

ALTERNATE PARTS LIST	
A03004	CONNECTOR - ROMEX
A03045	CORD - POWER 115V
A03046	CORD - POWER 230V
A04601	DIAPHRAGM - TEFLON/EPDM
A04611	DIAPHRAGM - 3 PLY TEFLON

ADC-200 06/24/21

**MOTOR DESCRIPTION:**  
A13055 1/3HP 100-120/200-240V 50/60Hz 1Ph

		<b>AIR DIMENSIONS INC.</b> DEERFIELD BEACH, FL. USA 33442 WWW.AIRDIMENSIONS.COM	
DATE	TITLE		
1/3/2011	H-Series Double Head TEFC Pump		
APPROVED BY	DWG NO	MODEL #	
FDM	H302-Fx-CC5	H302-Fx-CC5	
			SHEET 2 OF 2

07/21 (2194)