

4

3

2

1

**\*\*Parts List**

| ITEM | QTY | PART #  | DESCRIPTION     |
|------|-----|---------|-----------------|
| 1    | 2   | A02411  | BEARING         |
| 2    | 2   | A02465  | VALVEBODY       |
| 3    | 2   | A03469  | CAP             |
| 4    | 2   | A05401  | ECCENTRIC       |
| 5    | 1   | A06443  | BLUE FAN        |
| 6    | 1   | A06444  | WHITE FAN       |
| 7    | 2   | A08403  | HEAD            |
| 8    | 2   | A08461  | HOUSING         |
| 9    | 1   | A13402  | MOTOR           |
| 10   | 2   | A14401  | COUNTERWEIGHT   |
| 11   | 2   | A16407  | COVER PLATE     |
| 12   | 2   | A16461  | PLATE           |
| 13   | 2   | A18402  | TOLERANCE RING  |
| 14   | 2   | A18461  | CONNECTING ROD  |
| 15   | 2   | A19013  | SCREW           |
| 16   | 8   | A19021  | SCREW           |
| 17   | 8   | A19405B | HEAD BOLT       |
| 18   | 4   | A19419  | SCREW           |
| 19   | 2   | A19461  | HI-TEMP ADAPTOR |
| 20   | 2   | A19469  | SPACER          |
| 21   | 2   | A19477  | PLATE SCREW     |
| 22   | 8   | A23402  | LOCK WASHER     |
| 23   | 2   | *A04461 | DIAPHRAGM       |
| 24   | 2   | *A07411 | GASKET          |
| 25   | 2   | *A23405 | WASHER          |
| 26   | 2   | *A23461 | WASHER          |

\*\* The "Parts List" includes 316 SS wetted parts. For other options see the "Alternate and Optional Parts" list and the "Alternate Plate Screws" list.

| ALTERNATE AND OPTIONAL PARTS |                          |
|------------------------------|--------------------------|
| PART #                       | DESCRIPTION              |
| A02460                       | VALVEBODY - ALUM TFE CO  |
| A02465                       | VALVEBODY - 316ss        |
| A02466                       | VALVEBODY - ALUM         |
| A02469                       | VALVEBODY - 316ss TFE CO |
| A02495                       | VALVEBODY - SILCONERT    |
|                              |                          |
| A08403                       | HEAD - 316ss             |
| A08404                       | HEAD - ALUM              |
| A08407                       | HEAD - 316ss TFE CO      |
| A08408                       | HEAD - ALUM TFE CO       |
| A08493                       | HEAD - SILCONERT         |
|                              |                          |
| A16461                       | PLATE - 316ss            |
| A16465                       | PLATE - 316ss TFE CO     |
| A16491                       | PLATE - SILCONERT        |

ADC-121 02/18/19

| ALTERNATE PLATE SCREWS (ELEV.) |                                 |
|--------------------------------|---------------------------------|
| PART #                         | DESCRIPTION                     |
| A19473                         | PLATE SCREW ELEV - 316ss TFE CO |
| A19477                         | PLATE SCREW ELEV - 316ss        |
| A19495                         | PLATE SCREW ELEV - SILCONERT    |

**\*RECOMMENDED SPARE PART KIT**

|               |              |
|---------------|--------------|
| DIAPHRAGM KIT |              |
| 11463         | 2-PLY TEFLON |

INCLUDES ITEMS 23-26

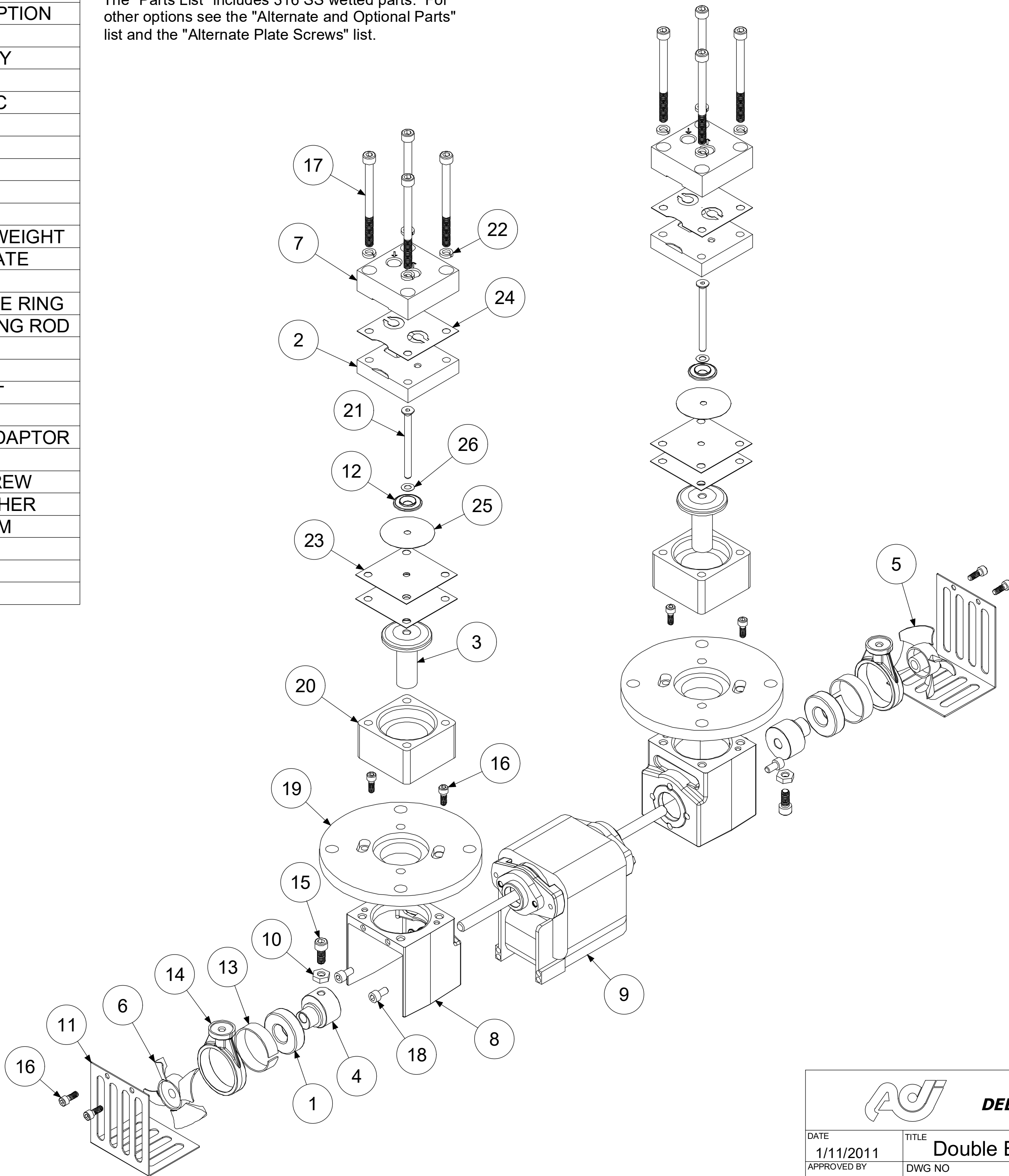

01/20 (2105)

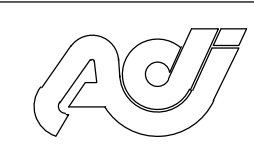

**AIR DIMENSIONS INC.**  
**DEERFIELD BEACH, FL. USA 33442**  
[WWW.AIRDIMENSIONS.COM](http://WWW.AIRDIMENSIONS.COM)

|                    |   |                          |
|--------------------|---|--------------------------|
| DATE<br>1/11/2011  | TITLE<br>Double Elevated Head B-Series Pump |                          |
| APPROVED BY<br>FDM | DWG NO<br>Bxx2-xx-AC5-L                     | MODEL #<br>Bxx2-xx-AC5-L |
|                    |   | SHEET 2 OF 2             |

4

3

2

1